



Quick Start & First Cut!

PLUS, setting up a jig ...

1 You should have arrived here after Hooking-Up with your Handibot with **Anchor Point (AP) mode**.

This is your Handibot's **Dashboard!** It might look a little different depending on the device and browser you're using.

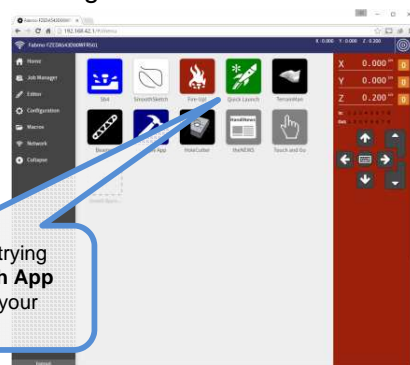

In a moment we'll be trying out the **Quick Launch App** to get you going with your new tool ...

2 Be sure to close the hood before you begin any cuts.



3 We'll be doing a test cut next, which won't generate a lot of dust. But, if you have a shopvac, you can insert a 1.25" hose into the dust port in the back of the Handibot.



4 Now let's try out your Handibot and do a test cut by clicking on the green **Quick Launch** App in the FabMo dashboard. Follow the in-app instructions before returning to this guide.

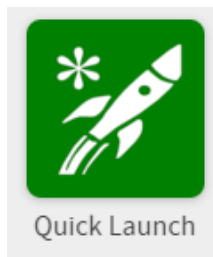

5 Hopefully **Quick Launch** got you started on understanding how your Handibot works, and you were able to make your first cut ...

*FYI, these instructions and other parts of the **Handibot Manual** are available on the web: docs.handibot.com*

- 6 When you've finished the test cut, turn off the Handibot and use the T-handle wrench supplied with the Handibot to remove the two bolts at the rear holding the wooden baseplate to your Handibot.



Refer to "Lumber Fixturing Jig" in handibot.docs.com to use the base as a useful Handibot accessory along with parts included in the accessory bag.

- 7 NOTE: Use the "Fire Up" app, in the FabMo dashboard, every time you use your Handibot to set the x, y, and z positioning.

What's Next?

- Click on "Next Steps" tab in Quick Launch app for included apps or download apps.
- Go to handibot.com for videos of projects and uses.
- Design your own project using VCarve Pro.
- Follow "The News"
- If you're ready to put your tool on a network, then have a look at the next document, [Hooking-Up: Network](#)

- 8 And, Wait! Before you throw out the MDF board that came bolted to your handibot—there's one more use for it! With a few steps you'll have a stand for your handibot that also works as a fence for cutting on long boards!



- 9 Locate the L shaped pieces with numbers carved on them.



- 10 Slide them into place in the slots as shown.

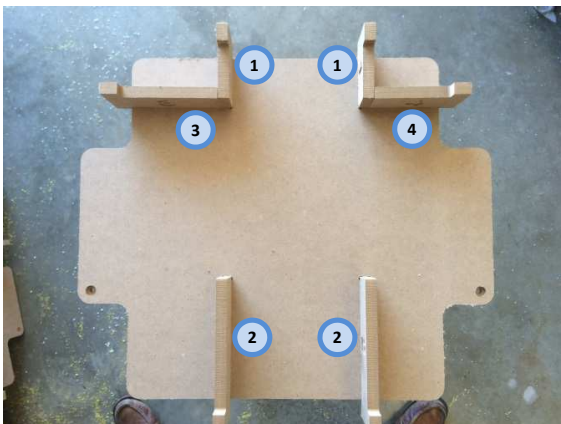

- 11 Hold the L shaped pieces tight while driving screws through the base to hold them in place.



12

Now you've got a simple jig for holding 6 and 8 inch boards!

